



# SOCIAL CONNECTEDNESS AND HYPER-LOCAL COMMUNITIES

# OUTLINE

How should we re-build Europe?

- *What challenges should we solve for?*
- *What learnings from the contemporary built environment in Copenhagen could guide us?*

# LONELINESS

*“In 2022, more than 33% of Europeans were lonely at least sometimes and 13% were lonely most of the time.”*

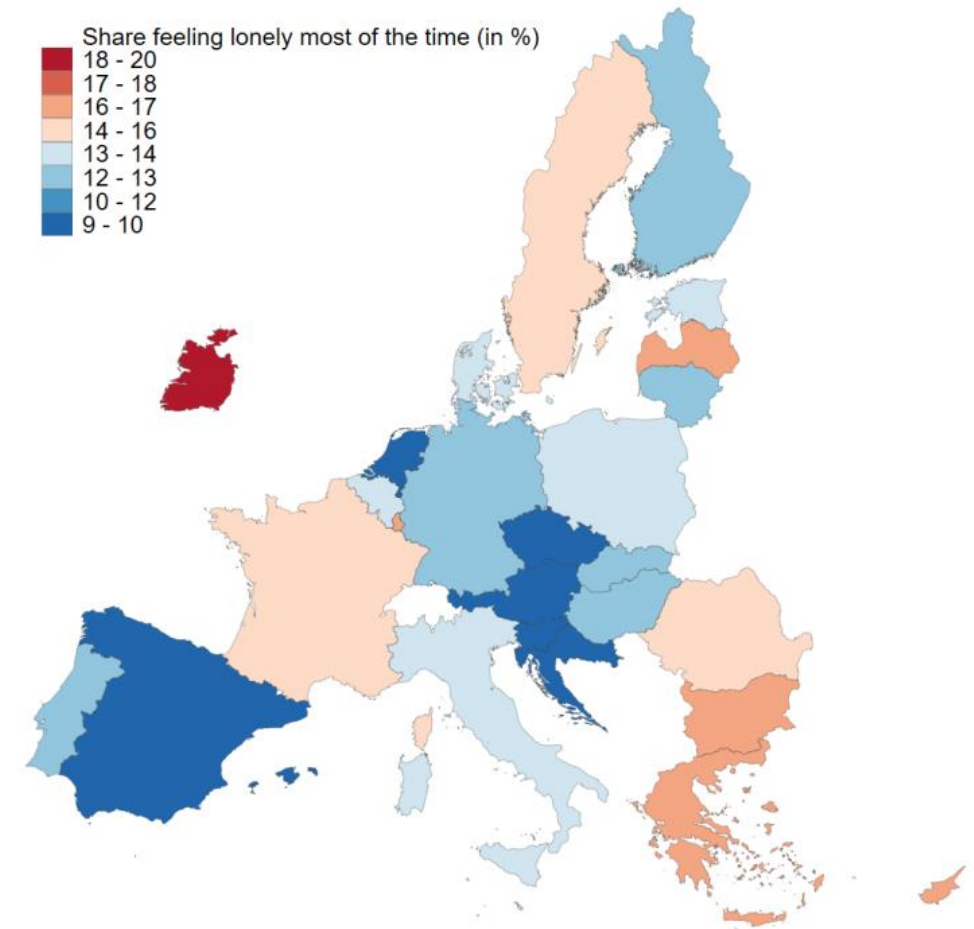

# LONELINESS AND COMMUNITIES

Covariates of loneliness:

- Psychological health problems
- Raised blood pressure
- Impaired sleep
- Lower levels of empathy
- Higher levels of distrust and intolerance towards others
  
- Lower social capital

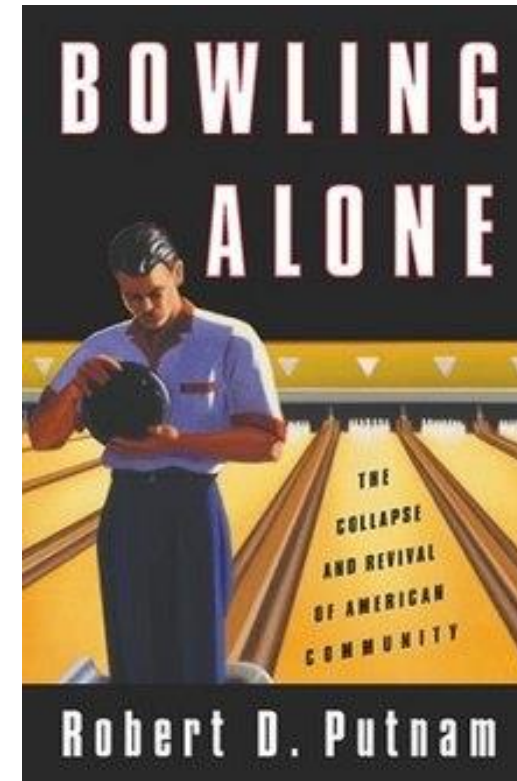

# THE FOUR HOUSING TYPES OF COPENHAGEN

Condominium (owner-occupied housing)



21.2%

Cooperatives (andelsbolig)



28.9%

Private rental



29.3%

Social housing



19.9%

# COMMUNITIES IN THE BUILT ENVIRONMENT

Evidence from *The Danes in the Built Environment 2023*

*“Common road/garden parties”*

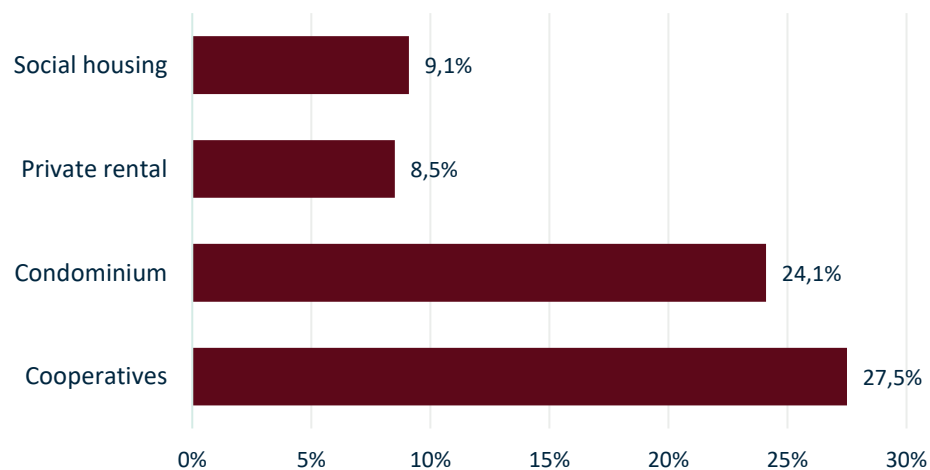

*“We have nothing to do with each other”*

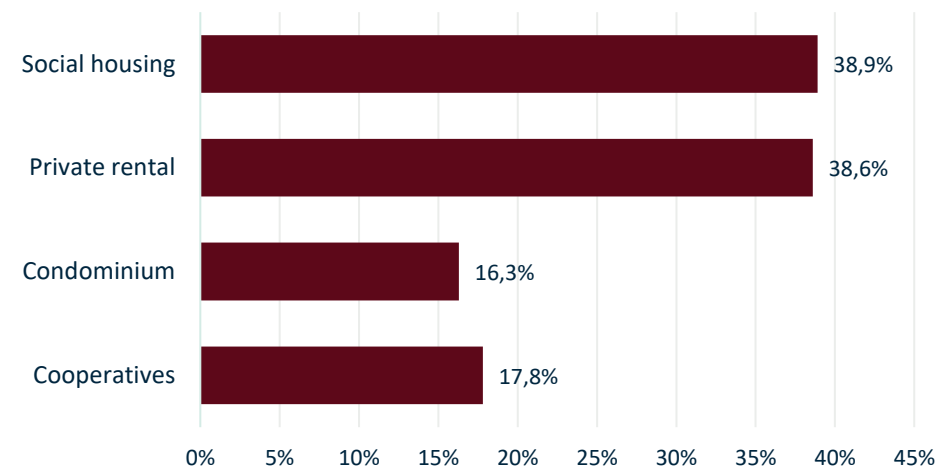

# RECENT HOUSING DEVELOPMENT IN COPENHAGEN

Massive boom in private rental housing

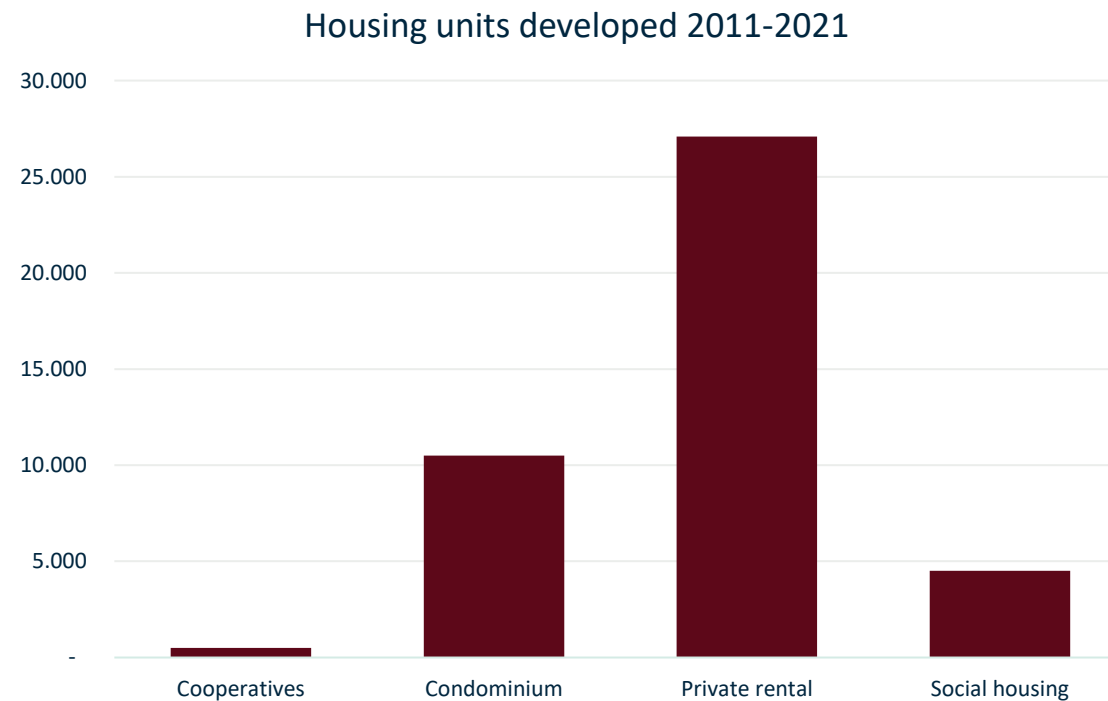

# A CASE FROM BALDER BOVIERAN

Danish wordplay: Live-at-the-Riviera

Coorporative housing for senior citizens



### Fællesspisning

Fælleshuset ligger i vinterhaven. Her kan I samles til fælles madlavning og fællesspisning og måske omkring højtidler fx til påskefrokost og julefrokost. Lokalet kan anvendes til alt mellem himmel og jord. Det er fantasien og jer som beboere, der bestemmer.

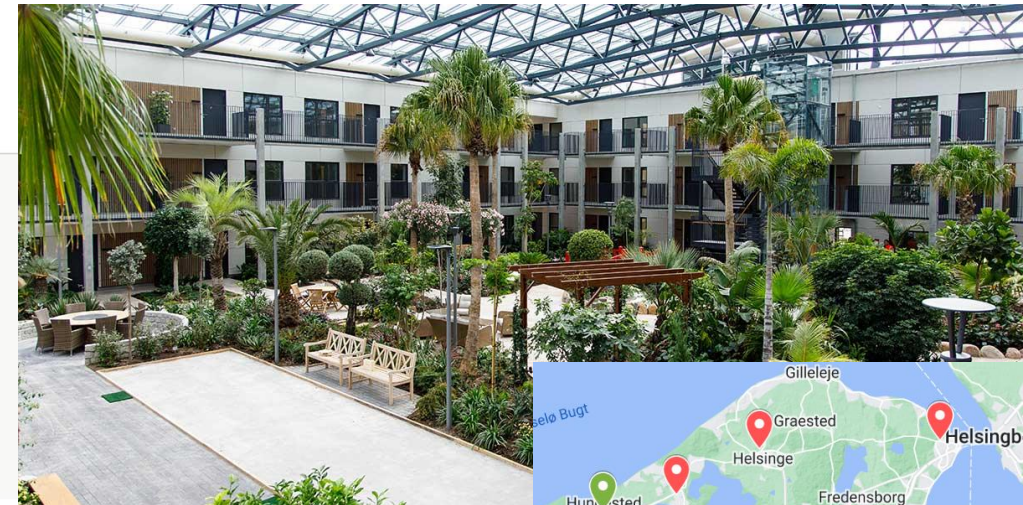

### Arranger aktiviteter ude af huset

Hvem kunne ikke tænke sig at have en at dele en biograf-teater- eller rejseoplevelse med? Her har du muligheden for at deltage i - eller måske arrangere en aktivitet ud af huset. Der kan naturligvis være kultur på programmet, men også sport i form af fx fælles gå-løbe-cykelture, svømning, bowling eller golf.

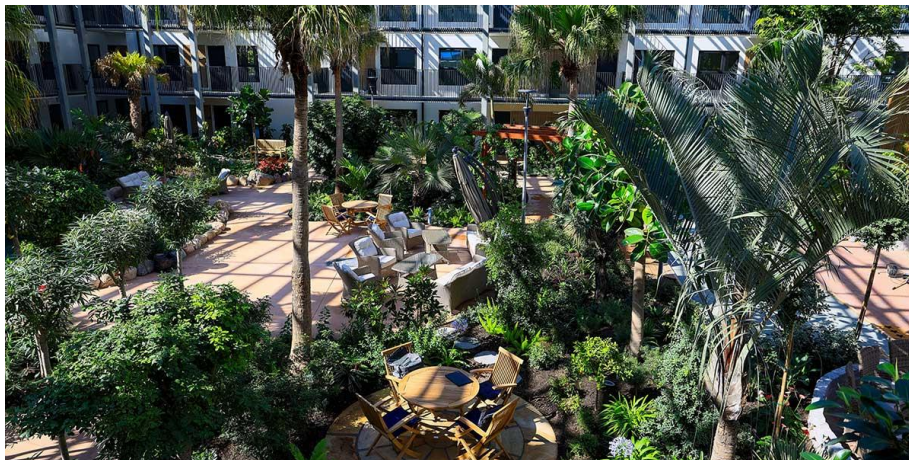
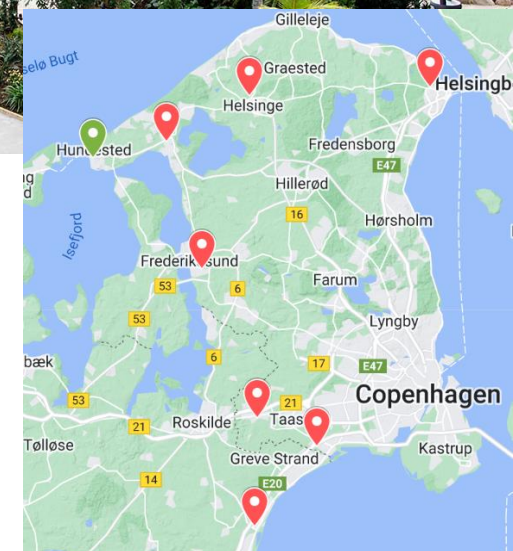



# CONCLUSIONS

How should we re-build Europe?

- *Challenges*
  - Loneliness
  - Social connectedness
- *Learnings from Copenhagen*
  - Be mindful of the impact on social connectedness and communities of what you build
  - When developing new housing, ask yourselves: *“is this a place where people will make friends?”*

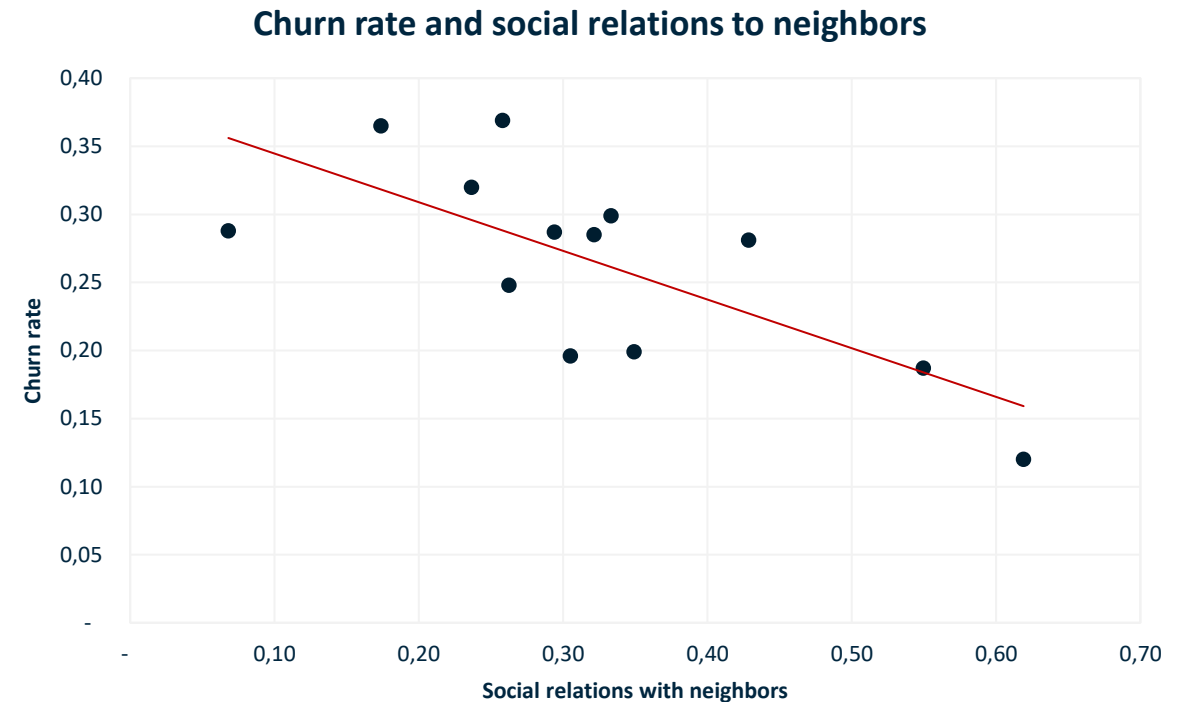

# THANK YOU!

Data & Analytics Manager, Balder Danmark A/S

[mathias.heinze@balder.dk](mailto:mathias.heinze@balder.dk)